

Single-View X-ray Intelligent Security Inspection System

The ISD-SG6040S-2CVL X-ray security inspection system is a new generation Hikvision X-ray security inspection system that integrates multi-functions such as intelligent detection, baggage connection, Raytina display, etc. This model is applicable to be deployed in scenarios such as customs, office buildings, large events, courts, prisons, embassies, factories, schools, hospitals, public places, etc. The size of the tunnel is suitable for boarding suitcase, small parcels, backpacks, envelopes, handbags, etc.



- **Material Classification:** Advanced material discrimination technology to recognize different materials and assign different colors (3 or 6 colors).
- **Intelligent Recognition:** Integrated with the advanced detection algorithm, which could detect more than 35 major types of target objects and alarm on them automatically.
- **Raytina HD Image:** Integrated with the new generation of image processing system, which could provide with a clearer X-ray image with high resolution.
- **Variable Speed:** One-click to switch the conveyor speed to fit different application scenarios.
- **HCP Remote Management:** Network integration supported real time status, X-ray images, videos, alarm information can be viewed remotely through HCP, and report can be viewed and downloaded remotely for better management process.

▪ Specifications

▪ Dimensions	
Tunnel Dimensions	620 mm (W) × 420 mm (H)
System Dimensions	2011 mm (L) × 887 mm (W) × 1260 mm (H)
▪ General Specifications	
Conveyor Height	600 mm
Conveyor Speed	0.2 m/s, 0.3 m/s, 0.4m/s adjustable
Max. Conveyor Capacity	180 kg (Even Distributed)
▪ Performance^[1]	
Wire Resolution	38/40 AWG
Penetration (Steel)	34/36 mm
▪ X-ray Generator	
Number of Generators	1
Anode Voltage / Current	160KV / 1.0mA(Adjustable)
Cooling / Working cycle	Oil-cooling / Continuous
▪ Health and Safety	
External dose rate	< 0.6 μSv/h (100mm Distance to the Housing)
Film Safe	Guaranteed up to ISO1600
▪ Detection Algorithm	
Prohibited Goods Detection	35 Major Types, over 64 categories
Others	Shield Alarms, Organic Alarms, etc.
▪ Integrated Cameras	
Cameras	3-ch, 1920 x 1080
Sensor Type	1/2.8" Progressive Scan CMOS
Video Compression Standard	H.265 / H.264 / MJPEG
▪ Installation Data	
Power Consumption	< 0.8 KVA
Power Supply	AC 220V (-15% to +10%) , 50Hz/60Hz (±3Hz); AC 110V (-15% to +10%) , 50Hz/60Hz (±3Hz);
Noise level	< 60 dB
Operating Temperature / Humidity	5 °C to 50 °C / 5 % to 95 % (non-condensing)
Storage Temperature / Humidity	-20 °C to 70 °C / 5 % to 95 % (non-condensing)
Weight	600 Kg
▪ Additional Features	
Image Processing	Color / Black & White(C/B&W), Organic Stripping(ORG-), Inorganic Stripping(INORG-), Negative, High / Low penetration(H/L), Absorptivity increase(ABS+), Absorptivity decrease(ABS-), Super Enhancement(SEN), Edge Enhancement(Edge), 64x seamless zoom in and out, etc.
Software Functions	HCP integration, Professional TIP system, Operation Intro, Photo and X-ray image connection, etc
Operation Display	21.5 inch Single Screen
Storage	100,000 +

^[1] Tested with HIKVISION Standard Test Piece.

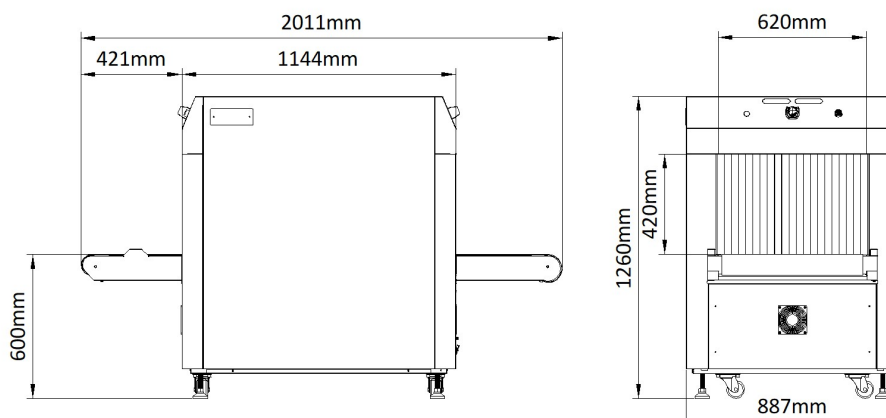

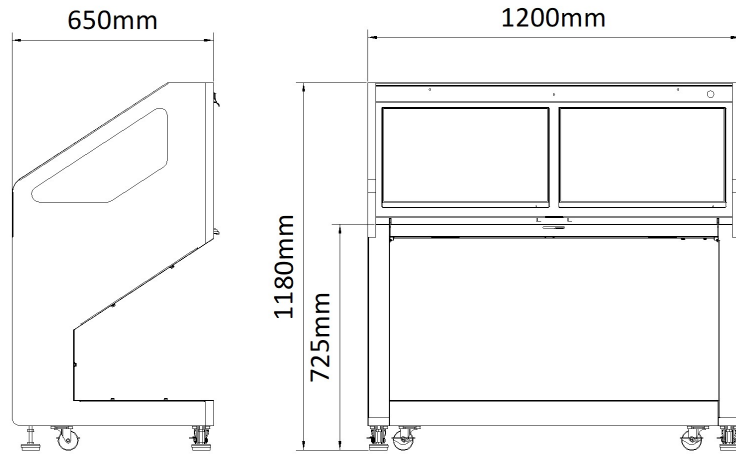

▪ Entrance and Exit roller table

